

TEKK® ASSEMBLY MANUAL

trainer

Congratulations on your new Tekk® Trainer! This assembly manual will guide you through the set-up of your new Tekk® Trainer. **Note: It is very important that you follow the instructions to ensure a quick and easy set-up of your Tekk® Trainer.**

Have fun! We here at Tekk® hope you will love practicing with your new Tekk® Trainer and enjoy using the same equipment used by the pros.

Parts:

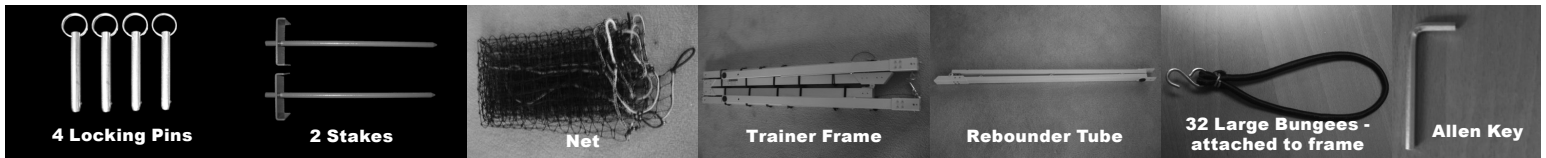

A Unfold Tekk® Trainer Frame

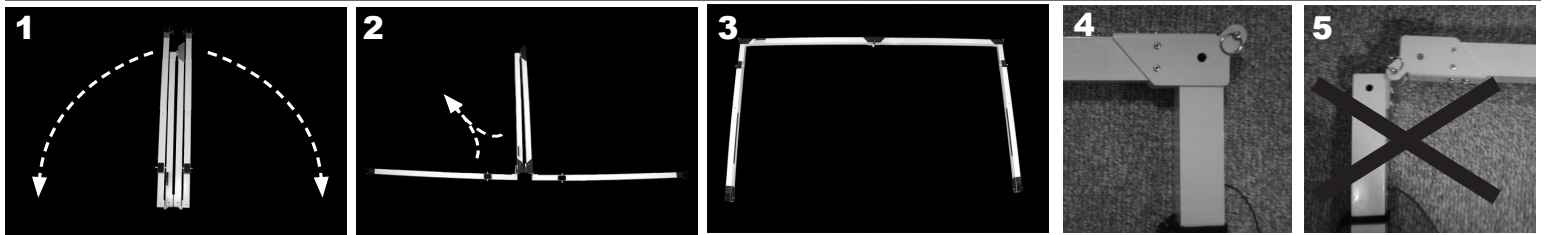

- 1 Place Trainer on the ground with Tekk® logos facing down.
- 2,3 Pull and swing Tekk® Trainer arms open.
(Top corners of Tekk® Trainer should look like #4, NOT #5)

B Raise Tekk® Trainer Legs & Lock



- 1 Raise Tekk® Trainer leg up 90 degrees.
- 2 Lower support bracket.
- 3 Align support bracket with holes on post and insert the locking pin into support bracket. **Support bracket locking pins should be inserted into the 5th hole from the lanyard during first time set-up.** Repeat for the other side of the goal.
- 4 Raise Tekk® Trainer upright.
- 5 Insert locking pins into the top corner brackets. (Locking pins should be inserted from the front side of the Tekk® Trainer out through the back side of the Tekk® Trainer.)

C Attach Rebounder Tube to Frame

- 1 Unfold rebounder tube
- 2 Make sure pin is positioned towards the front side of the rebounder tube.
- 3-4 Place the hole on the skid bracket on top of pin on rebounder tube.

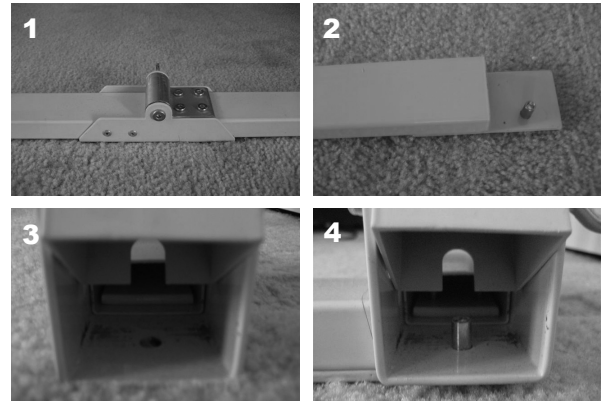

D Attach Net to Frame

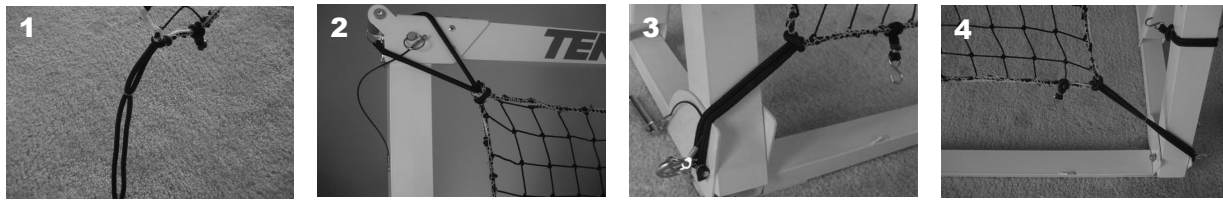

- 1 Identify bungee with a double loop. Make sure this is on the bottom right side before you begin attaching net to the frame
- 2 Attach the two top corner loops (one at a time) over the top corners of the frame
- 3 Attach the corner loop over the eye bolt on the bottom left side of the frame – same side as Tekk® logo on the net
- 4 Attach the bungee with double loop over the eye bolt on the bottom right side of the frame. NOTE: THIS BUNGEE WILL ALWAYS BE ATTACHED LAST AS IT IS LONGER.

E Attach Bungees to Net

You received an extra bungee with hook in the box. You will use this as a tool to attach the net to the frame. See pics 1 & 2. We recommend using two people to attach the net to the bungees as it is very tight. One person pulls the net towards the frame and the other person pulls the bungee hook towards the net.



- 1 Attach bungees on bottom tube to net
- 2 Attach bungees on top tube to net
- 3 Attach bungees on side tubes to net

F Stake Tekk Trainer to Ground

- 1 For outdoor use, drive stakes into ground through holes in the middle of each Tekk® Trainer leg. The Tekk® Trainer has friction pads on the bottom of the legs for indoor use. We recommend always anchoring the Tekk® Trainer for complete safety.

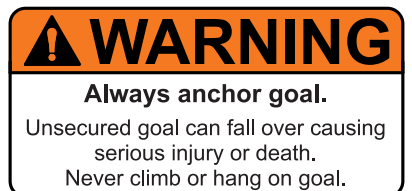
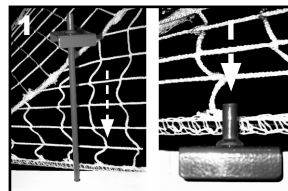

IMPORTANT INFORMATION

- 1 You may notice one side of the frame is sitting slightly off the ground before you attach the bungees. This is by design. After you attach the bungees the frame will sit flat on the ground.
- 2 After you attach the bungees you will notice the rebounder tube is slightly up in the middle. This is by design so the rebounder tube doesn't hit the ground.
- 3 You will see the center bracket has two extra holes on it. These holes are for customers that purchase a goal upgrade. Nothing goes into these holes for the Tekk® Trainer; you are not missing any parts.

TEKK[®] trainer **WARRANTY INFORMATION**

Product Registration

Thank you for purchasing the Tekk® Trainer. To register your warranty and for it to be in effect please email your name, address, email, telephone number along with the name of the Tekk® product you purchased, order number and where you purchased the product to customerservice@tekk.com with the subject heading, "Warranty Registration". We will keep your purchase information on file to keep you informed of product alerts or updates regarding the specific product you purchased.

RETAIN YOUR PROOF OF PURCHASE

Please retain your receipt for any future warranty claims

One Year Warranty

Subject to the provisions provided below, this Tekk® product has a one year warranty against defects in material and workmanship.

Should a Tekk® product fail to perform as described above for the warranted period, contact Tekk® Customer Service at 1-888-510-8355, it will be repaired or replaced with the same or functionally equivalent product by Tekk®, at its discretion, free of charge provided you: (1) return the failed product to a Tekk® designated repair facility with the shipping charge prepaid, and (2) provide Tekk® with proof of the original date of purchase. Repaired or replacement products will be returned to you with shipping charges prepaid.

Warranty is limited to factory-provided replacement parts, factory repair or replacement, at the discretion of Tekk®. This warranty does not apply if, in the judgment of Tekk®, the product fails due to damage from shipment, handling, storage, accident, abuse, misuse, improper set-up, use for other than intended purpose, normal deterioration of products due to weather and wear and tear. All warranties are invalidated by non-factory modifications and unauthorized repairs, which will immediately terminate all liability by Tekk® for the product or damages caused by its use. The buyer and its customers shall be responsible for proper set-up and use of the products as outlined in the product assembly/instruction manual.

Prior to returning any defective product, the customer must obtain a Return Goods Authorization number (RGA) from Tekk®. All defective products should be returned to Tekk® with shipping charges prepaid. Tekk® will not accept collect shipments or returns without a RGA number.

The warranty set forth herein is the sole and exclusive warranty provided by Tekk®. There are no other warranties, representations or guarantees provided by Tekk® either expressed or implied, including warranties of merchantability and fitness for a particular purpose. In no event will Tekk® be liable for incidental, consequential or special damages, even if such damages result from negligence or other fault. Some states do not allow the exclusion or limitation of incidental or consequential damages, so the limitations or exclusions may not apply to you. This warranty gives you specific legal rights, and you may also have other legal rights which vary from state to state.

ADDRESS ALL INQUIRIES CONCERNING YOUR TEKK® PRODUCT WARRANTY TO: TEKK® ATHLETIC, INC., ATTN: CUSTOMER SERVICE DEPARTMENT 10900 N.E. FOURTH STREET, SUITE 2300 BELLEVUE, WA 98004, 1-888-510-8355 or email customerservice@tekk.com.

Visit the Tekk® Trainer website at www.tekk.com.

